

***PRESS FITTINGS
FOR MULTILAYER PIPE***

**RACCORDI A PRESSARE
PER TUBO MULTISTRATO**



EN

IT



PRESS FITTINGS FOR MULTILAYER PIPE / RACCORDI A PRESSARE PER TUBO MULTISTRATO

TYPE OF PRODUCT

Brass press fittings

FUNCTION

Fittings for sanitary water supply system
Fittings for heating systems

SYSTEM

The Comisa Press EVO fittings form, alongside the Comisa multilayer pipe, the Comisa Press system.
The compatibility of the fittings with multilayer pipes manufactured by others or of different type must be expressly approved by Comisa S.p.A. which, after executing its tests protocol, shall issue a guarantee certificate.

INSTRUCTIONS FOR USE

Use TH-profile pressing clamps with dimension suitable for the size of the fitting to be installed. Please follow the instructions provided by Comisa strictly.

THREADS

EN 10226 male threads
ISO 228 female threads

PERFORMANCE

| | |
|-------------------------------|--------------|
| Maximum operating pressure | 10 bars |
| Maximum operating temperature | 95°C |
| Maximum peak temperature | 110°C (1 hr) |

Data refers to the Comisa Press system combined with Comisa multilayer pipe according to the UNI-EN-21003 standard.

PRESS CONTROLL

Press test to identify possible fittings not suitably pressurised to a maximum of 4.5 bars.

WARRANTY

10 years. Such warranty shall not be deemed valid in case:

- Installation is not carried out according to the installation instructions indicated in the Comisa S.p.A. publications
- The circuit is used for conveying liquids different from those indicated in the Comisa S.p.A. publications
- Liquids are introduced into the circuit at pressure and temperature values different from the respective restrictions indicated in the Comisa S.p.A. publications

CERTIFICATES

The Comisa Press system is certified by DVGW (n. DW-8501BO0049)

TIPOLOGIA PRODOTTO

Raccordi a pressare in ottone

FUNZIONE

Raccordi per impianti di adduzione acqua sanitaria
Raccordi per impianti di riscaldamento

SISTEMA

I raccordi Comisa Press compongono, unitamente al tubo multistrato Comisa, il sistema Comisa Press.
La compatibilità dei raccordi con tubo multistrato di altro produttore o di diversa tipologia deve essere esplicitamente richiesta a Comisa S.p.A. che, dopo avere attuato un proprio protocollo di prove, rilascerà una certificazione di garanzia.

SPECIFICHE PER L'UTILIZZO

Utilizzare ganasce per pressatura con profilo TH della dimensione adatta alla misura del raccordo da installare.
Seguire scrupolosamente le istruzioni fornite da Comisa.

FILETTATURE

Filettature maschio EN 10226
Filettature femmina ISO 228

PRESTAZIONI

| | |
|------------------------------|-------------|
| Pressione max di esercizio | 10 bar |
| Temperatura max di esercizio | 95°C |
| Temperatura max di picco | 110°C (1 h) |

I dati sono riferiti al sistema Comisa Press abbinati a tubo multistrato Comisa secondo la norma UNI-EN-21003.

PRESS CONTROLL

Pressione di prova per individuare eventuali raccordi non pressati max 4,5 bar.

GARANZIA

10 anni. Tale garanzia decade qualora:

- l'installazione non avvenga secondo le istruzioni di montaggio riportate nelle pubblicazioni di Comisa S.p.A.
- Il sistema venga impiegato per condurre liquidi diversi da quelli riportati nelle pubblicazioni di Comisa S.p.A.
- Nel sistema vengano immessi liquidi a valori di pressione e temperatura diversi dai rispettivi limiti riportati nelle pubblicazioni di Comisa S.p.A.

CERTIFICAZIONI

Il sistema Comisa Press è certificato da DVGW (n. DW-8501BO0049)

PRESS FITTINGS FOR MULTILAYER PIPE / RACCORDI A PRESSARE PER TUBO MULTISTRATO

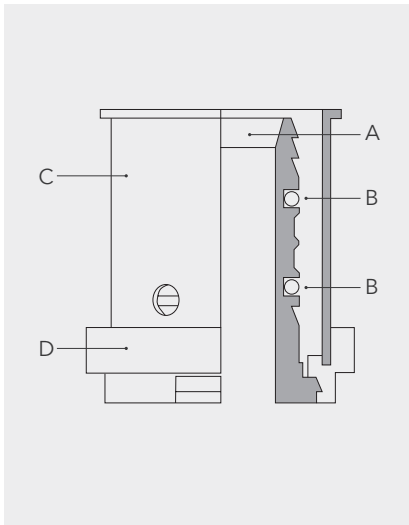

- A** Body: EN 12165 CW617N brass suitable for the passage of nutritional liquids intended for human consumption
- B** O-Ring: 2 O.R.made with EPDM-peroxide blend
- C** Collar: AISI 304 DIN EN 10088-2 stainless steel subjected to a solubilisation process
- D** Clip ring: made of PE-LD low density polyethylene. The profile of the clip further provides an accurate abutment for the TH clamp

- A** Corpo: ottone EN 12165 CW617N adatto per il passaggio di liquidi alimentari destinati al consumo umano.
- B** O Ring: 2 O.R. realizzati con miscela EPDM-perossidico.
- C** Bussolotto: ACCIAIO AISI 304 [EN 10088-2] inox nichel-cromo 18/8 sottoposto a processo di solubilizzazione.
- D** Anello a clip: in PE-LD, polietilene a bassa densità. La forma della clip fornisce inoltre un riscontro preciso alla pinza TH.

TABLE FOR CALCULATING LOCALISED FRICTION LOSSES (EXPRESSED IN EQUIVALENT PIPE METRES) EQUIVALENT LENGTHS

/ TABELLA PER IL CALCOLO DELLE PERDITE DI CARICO LOCALIZZATE (ESPRESSE IN METRI EQUIVALENTI DI TUBO) LUNGHEZZE EQUIVALENTI

| Ø 16 x 2,0 | 0,8 | 0,7 | 0,6 | 1,40 | 1,80 | 0,35 | 0,80 |
|------------|------|------|------|------|-------|------|------|
| Ø 18 x 2,0 | 1,00 | 0,90 | 0,80 | 1,60 | 2,10 | 0,45 | 1,00 |
| Ø 20 x 2,5 | 1,10 | 1,00 | 0,90 | 1,70 | 2,20 | 0,45 | 1,10 |
| Ø 20 x 2,0 | 1,30 | 1,15 | 1,00 | 1,90 | 2,70 | 0,50 | 1,30 |
| Ø 26 x 3,0 | 1,80 | 1,60 | 1,40 | 2,50 | 4,30 | 0,65 | 1,80 |
| Ø 32 x 3,0 | 2,70 | 2,30 | 2,00 | 4,20 | 6,30 | 0,85 | 2,70 |
| Ø 40 x 3,5 | 3,00 | 2,60 | 2,30 | 5,00 | 7,50 | 1,00 | 3,00 |
| Ø 50 x 4,0 | 4,60 | 4,20 | 3,80 | 6,70 | 10,00 | 1,30 | 4,60 |



INSTALLATION / INSTALLAZIONE

1



CUT
/ TAGLIO

2



CALIBRATION
/ CALIBRATURA

3

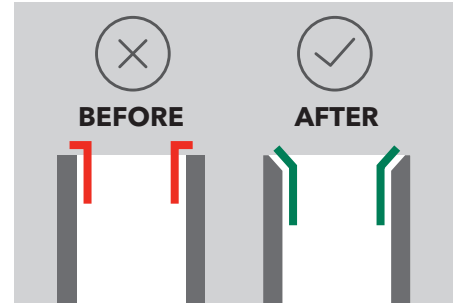

PIPE CALIBRATION
/ CALIBRAZIONE DEL TUBO

4

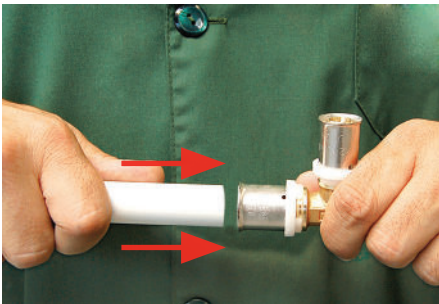

INSERTING THE FITTING
/ MONTAGGIO DEL RACCORDO

5

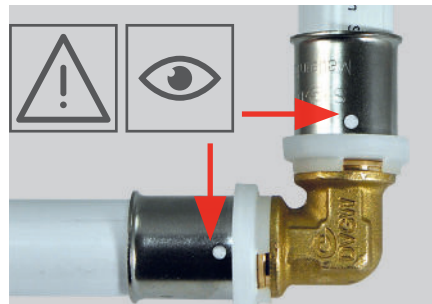

VISUAL INSPECTION
/ CONTROLLO VISIVO

6

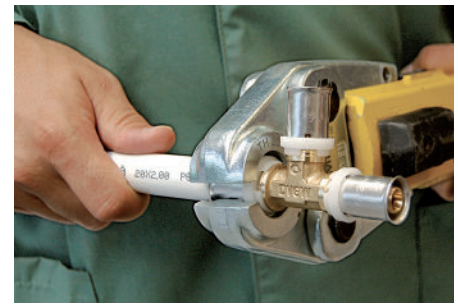

PRESSING
/ PRESSATURA

COMISA PRESS CONTROL



FITTING NOT PRESSED
/ RACCORDO NON PRESSATO



**FITTING NOT PRESSED AND TESTED
BETWEEN 1 AND 4,5 BAR - IT LEAKS**
/ RACCORDO NON PRESSATO PROVATO DA 1
FINO A 4,5 BAR - PERDE



**FITTING PRESSED AND TESTED
BETWEEN 1 AND 4,5 BAR - IT DOESN'T LEAK**
/ RACCORDO PRESSATO PROVATO - NON PERDE



CLAMPING JAW PROFILE TO BE USED WITH COMISA PRESS FITTINGS

/ PROFILO GANASCE DA UTILIZZARE CON RACCORDI COMISA PRESS SYSTEM

WARNING!

COMISA PRESS SERIES

Following the introduction on the market of multilayer pipes or fittings of uncontrolled origin, in order to protect their customers, Comisa S.p.A. states as follows:

CLAMPING JAW PROFILES COMPATIBLE WITH COMISA PRESS SYSTEM

The COMISA PRESS system, DVGW Certificate No. DW-8501BO0049, includes:

- COMISA PRESS Fittings
- COMISA Multilayer pipe
- Jaws TH Profile

COMISA ensures the compatibility of the jaws H or B only when used with the COMISA PRESS System:

COMISA Multilayer pipe + fittings. Regarding the use of pipe or fittings of other producers and/or of other sources, COMISA does not guarantee the compatibility, if not after the customer's request, following which COMISA will implement its test procedure for inspection. After successful testing, COMISA will issue a certificate of guarantee.

Warning:

THE PIPE CALIBRATION IS IMPORTANT AND MUST BE MADE WITH CHIP REMOVAL CALIBRATORS.
DO NOT USE CALIBRATORS FOR PE-X AS NOT ADEQUATE.

/ ATTENZIONE!

SERIE COMISA PRESS

A seguito della immissione sul mercato di tubi multistrato o di raccorderie di incontrollata provenienza, al fine di tutelare la propria clientela, COMISA S.p.A. precisa quanto segue:

PROFILI GANASCE COMPATIBILI CON COMISA PRESS SYSTEM

Il sistema COMISA PRESS SYSTEM, certificato DVGW No. DW-8501BO0049, è composto da:

- Raccordi COMISA PRESS
- Tubo multistrato COMISA
- Ganasce profilo TH

COMISA garantisce la compatibilità delle ganasce H o B solo se utilizzate con sistema COMISA PRESS: raccordi + tubo multistrato COMISA. Per quanto riguarda l'utilizzo di tubo o di raccorderie di altro produttore e/o di altra provenienza, non si garantisce la compatibilità, se non previa richiesta del cliente, a seguito della quale COMISA attuerà il proprio protocollo di test per la verifica stessa. Ad esito positivo delle prove, COMISA rilascerà una certificazione di garanzia.

Attenzione:

LA CALIBRAZIONE DEL TUBO È IMPORTANTISSIMA E DEVE ESSERE FATTA CON CALIBRATORI AD ASPORTAZIONE DI TRUCIOLO.
NON UTILIZZARE CALIBRATORI PER TUBO PE-X IN QUANTO NON ADEGUATI.



Ø COMPATIBLE WITH H/B JAWS

/ Ø COMPATIBILE CON GANASCE H/B

| TH | H | B |
|----|----|----|
| 14 | 14 | 14 |
| 16 | 16 | 16 |
| 18 | 18 | 18 |
| 20 | 20 | 20 |
| 25 | 26 | 26 |
| 26 | 32 | 32 |
| 32 | | |
| 40 | | |
| 50 | | |
| 63 | | |
| 75 | | |



PRESS FITTINGS FOR MULTILAYER PIPE / RACCORDI A PRESSARE PER TUBO MULTISTRATO

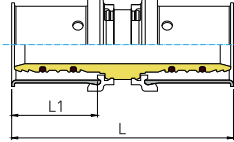

STRAIGHT COUPLER
/ RACCORDO DIRITTO

870

| SIZE (mm) | L | L1 | CODE | TECH. CODE |
|-----------|-----|----|-----------|--------------|
| 14 x 2 | 64 | 25 | 87.10.140 | MU0870000140 |
| 16 x 2 | 64 | 25 | 87.10.160 | MU0870000160 |
| 16 x 2,25 | 64 | 25 | 87.10.161 | MU0870000560 |
| 17 x 2 | 64 | 25 | 87.10.170 | MU0870000170 |
| 18 x 2 | 64 | 25 | 87.10.180 | MU0870000180 |
| 20 x 2 | 64 | 25 | 87.10.200 | MU0870000200 |
| 20 x 2,5 | 64 | 25 | 87.10.201 | MU0870000510 |
| 25 x 2,5 | 64 | 25 | 87.10.250 | MU0870000250 |
| 26 x 3 | 64 | 25 | 87.10.260 | MU0870000260 |
| 32 x 3 | 66 | 25 | 87.10.320 | MU0870000320 |
| 40 x 3,5 | 71 | 25 | 87.10.400 | MU0870000400 |
| 50 x 4 | 89 | 37 | 87.10.500 | MU0870000500 |
| 63 x 6 | 83 | 37 | 87.10.631 | MU0870000630 |
| 75 x 5 | 116 | 53 | - | MU0870000750 |

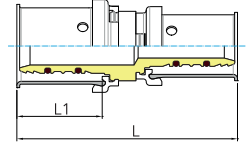

REDUCING COUPLER
/ RACCORDO DIRITTO RIDOTTO

870R

| SIZE (mm) | L | L1 | CODE | TECH. CODE |
|-------------------|-----|-------|-----------|--------------|
| 16 x 2 - 14 x 2 | 64 | 25 | 87.11.160 | MU0870R16140 |
| 18 x 2 - 16 x 2 | 64 | 25 | 87.11.181 | MU0870R18160 |
| 20 x 2 - 14 x 2 | 64 | 25 | 87.11.200 | MU0870R20140 |
| 20 x 2 - 16 x 2 | 64 | 25 | 87.11.201 | MU0870R20160 |
| 20 x 2 - 18 x 2 | 64 | 25 | 87.11.203 | MU0870R20180 |
| 25 x 2,5 - 16 x 2 | 64 | 25 | 87.11.250 | MU0870R25160 |
| 25 x 2,5 - 20 x 2 | 64 | 25 | 87.11.252 | MU0870R25200 |
| 26 x 3 - 16 x 2 | 64 | 25 | 87.11.260 | MU0870R26160 |
| 26 x 3 - 18 x 2 | 64 | 25 | 87.11.262 | MU0870R26180 |
| 26 x 3 - 20 x 2 | 64 | 25 | 87.11.263 | MU0870R26200 |
| 32 x 3 - 16 x 2 | 66 | 25 | 87.11.320 | MU0870R32160 |
| 32 x 3 - 20 x 2 | 66 | 25 | 87.11.322 | MU0870R32200 |
| 32 x 3 - 26 x 3 | 66 | 25 | 87.11.325 | MU0870R32260 |
| 40 x 3,5 - 26 x 3 | 71 | 25 | 87.11.401 | MU0870R40260 |
| 40 x 3,5 - 32 x 3 | 71 | 25 | 87.11.402 | MU0870R40320 |
| 50 x 4 - 32 x 3 | 83 | 37-25 | 87.11.501 | MU0870R50320 |
| 50 x 4 - 40 x 3,5 | 83 | 37-25 | 87.11.600 | MU0870R50400 |
| 63 x 6 - 40 x 3,5 | 75 | 37-25 | 87.11.640 | MU0870R63400 |
| 63 x 6 - 50 x 4 | 84 | 37-37 | 87.11.650 | MU0870R63500 |
| 75 x 5 - 40 x 3,5 | 95 | 53-25 | - | MU0870R75400 |
| 75 x 5 - 50 x 4 | 104 | 53-37 | - | MU0870R75500 |



PRESS FITTINGS FOR MULTILAYER PIPE / RACCORDI A PRESSURE PER TUBO MULTISTRATO

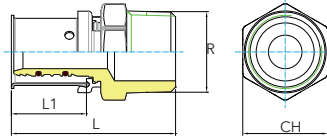

MALE COUPLER

/ RACCORDO DIRITTO MASCHIO

871

| SIZE (mm) | L | L1 | R | CH | CODE | TECH. CODE |
|-------------------|-----|----|--------|----|-----------|--------------|
| 14 x 2 - 1/2" | 50 | 25 | 1/2" | 22 | 87.12.140 | MU0871005140 |
| 16 x 2 - 3/8" | 50 | 25 | 3/8" | 19 | 87.12.150 | MU0871003160 |
| 16 x 2 - 1/2" | 50 | 25 | 1/2" | 22 | 87.12.160 | MU0871005160 |
| 16 x 2,25 - 1/2" | 50 | 25 | 1/2" | 22 | 87.12.161 | MU0871005560 |
| 16 x 2 - 3/4" | 54 | 25 | 3/4" | 28 | 87.12.164 | MU0871007160 |
| 18 x 2 - 1/2" | 50 | 25 | 1/2" | 22 | 87.12.180 | MU0871005180 |
| 18 x 2 - 3/4" | 54 | 25 | 3/4" | 28 | 87.12.181 | MU0871007180 |
| 20 x 2 - 1/2" | 50 | 25 | 1/2" | 22 | 87.12.200 | MU0871005200 |
| 20 x 2 - 3/4" | 54 | 25 | 3/4" | 28 | 87.12.201 | MU0871007200 |
| 20 x 2,5 - 1/2" | 50 | 25 | 1/2" | 22 | 87.12.202 | MU0871005510 |
| 20 x 2,5 - 3/4" | 54 | 25 | 3/4" | 28 | 87.12.203 | MU0871007510 |
| 25 x 2,5 - 3/4" | 54 | 25 | 3/4" | 37 | 87.12.250 | MU0871007250 |
| 25 x 2,5 - 1" | 57 | 25 | 1" | 34 | 87.12.251 | MU0871010250 |
| 26 x 3 - 1/2" | 54 | 25 | 1/2" | 28 | 87.12.255 | MU0871005260 |
| 26 x 3 - 3/4" | 54 | 25 | 3/4" | 28 | 87.12.260 | MU0871007260 |
| 26 x 3 - 1" | 57 | 25 | 1" | 34 | 87.12.261 | MU0871010260 |
| 32 x 3 - 1" | 57 | 25 | 1" | 34 | 87.12.320 | MU0871010320 |
| 32 x 3 - 1 1/4" | 62 | 25 | 1 1/4" | 43 | 87.12.321 | MU0871012320 |
| 40 x 3,5 - 1" | 60 | 25 | 1" | 43 | 87.12.400 | MU0871010400 |
| 40 x 3,5 - 1 1/4" | 62 | 25 | 1 1/4" | 43 | 87.12.401 | MU0871012400 |
| 50 x 4 - 1 1/4" | 72 | 37 | 1 1/4" | 51 | 87.12.500 | MU0871012500 |
| 50 x 4 - 1 1/2" | 72 | 37 | 1 1/2" | 51 | 87.12.501 | MU0871015500 |
| 63 x 6 - 2" | 85 | 37 | 2" | 60 | 87.12.631 | MU0871020630 |
| 75 x 5 - 2 1/2" | 101 | 53 | 2 1/2" | 85 | - | MU0871025750 |

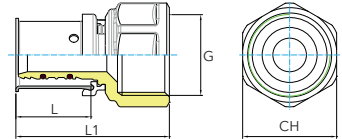

FEMALE COUPLER

/ RACCORDO DIRITTO FEMMINA

880

| SIZE (mm) | L | L1 | G | CH | CODE | TECH. CODE |
|-------------------|----|----|--------|----|-----------|--------------|
| 14 x 2 - 1/2" | 50 | 25 | 1/2" | 25 | 87.13.140 | MU0880005140 |
| 16 x 2 - 1/2" | 50 | 25 | 1/2" | 25 | 87.13.160 | MU0880005160 |
| 16 x 2,25 - 1/2" | 50 | 25 | 1/2" | 25 | 87.13.161 | MU0880005560 |
| 16 x 2 - 3/4" | 50 | 25 | 3/4" | 31 | 87.13.164 | MU0880007160 |
| 18 x 2 - 1/2" | 50 | 25 | 1/2" | 25 | 87.13.180 | MU0880005180 |
| 18 x 2 - 3/4" | 50 | 25 | 3/4" | 31 | 87.13.181 | MU0880007180 |
| 20 x 2 - 1/2" | 50 | 25 | 1/2" | 25 | 87.13.200 | MU0880005200 |
| 20 x 2 - 3/4" | 50 | 25 | 3/4" | 31 | 87.13.201 | MU0880007200 |
| 20 x 2,5 - 1/2" | 50 | 25 | 1/2" | 25 | 87.13.202 | MU0880005510 |
| 20 x 2,5 - 3/4" | 50 | 25 | 3/4" | 31 | 87.13.203 | MU0880007510 |
| 25 x 2,5 - 3/4" | 50 | 25 | 3/4" | 31 | 87.13.250 | MU0880007250 |
| 25 x 2,5 - 1" | 50 | 25 | 1" | 38 | 87.13.251 | MU0880010250 |
| 26 x 3 - 1/2" | 50 | 25 | 1/2" | 27 | 87.13.255 | MU0880005260 |
| 26 x 3 - 3/4" | 50 | 25 | 3/4" | 31 | 87.13.260 | MU0880007260 |
| 26 x 3 - 1" | 53 | 25 | 1" | 38 | 87.13.261 | MU0880010260 |
| 32 x 3 - 1" | 53 | 25 | 1" | 38 | 87.13.320 | MU0880010320 |
| 32 x 3 - 1 1/4" | 57 | 25 | 1 1/4" | 47 | 87.13.321 | MU0880012320 |
| 40 x 3,5 - 1" | 57 | 25 | 1" | 47 | 87.13.400 | MU0880010400 |
| 40 x 3,5 - 1 1/4" | 57 | 25 | 1 1/4" | 47 | 87.13.401 | MU0880012400 |
| 40 x 3,5 - 1 1/2" | 57 | 25 | 1 1/2" | 54 | 87.13.405 | MU0880015400 |
| 50 x 4 - 1 1/4" | 62 | 37 | 1 1/4" | 50 | 87.13.500 | MU0880012500 |
| 50 x 4 - 1 1/2" | 66 | 37 | 1 1/2" | 54 | 87.13.501 | MU0880015500 |
| 63 x 6 - 2" | 73 | 37 | 2" | 70 | 87.13.631 | MU0880020630 |
| 75 x 5 - 2 1/2" | 93 | 53 | 2 1/2" | 85 | - | MU0880025750 |



PRESS FITTINGS FOR MULTILAYER PIPE
/ RACCORDI A PRESSARE PER TUBO MULTISTRATO

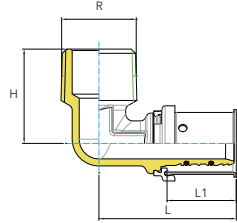

MALE ELBOW 90°
/ GOMITO 90° MASCHIO

861

| SIZE (mm) | L | L1 | H | R | CODE | TECH. CODE |
|-------------------|----|----|----|--------|-----------|--------------|
| 16 x 2 - 1/2" | 47 | 25 | 28 | 1/2" | 87.16.160 | MU0861005160 |
| 16 x 2,25 - 1/2" | 47 | 25 | 28 | 1/2" | 87.16.161 | MU0861005560 |
| 16 x 2 - 3/4" | 49 | 25 | 34 | 3/4" | 87.16.164 | MU0861007160 |
| 16 x 2 - 3/8" | 47 | 25 | 28 | 3/8" | - | MU0861003160 |
| 18 x 2 - 1/2" | 47 | 25 | 31 | 1/2" | 87.16.180 | MU0861005180 |
| 20 x 2 - 1/2" | 47 | 25 | 31 | 1/2" | 87.16.200 | MU0861005200 |
| 20 x 2 - 3/4" | 49 | 25 | 34 | 3/4" | 87.16.201 | MU0861007200 |
| 20 x 2,5 - 1/2" | 47 | 25 | 31 | 1/2" | 87.16.202 | MU0861005510 |
| 20 x 2,5 - 3/4" | 49 | 25 | 34 | 3/4" | 87.16.203 | MU0861007510 |
| 25 x 2,5 - 3/4" | 49 | 25 | 39 | 3/4" | 87.16.250 | MU0861007250 |
| 26 x 3 - 3/4" | 49 | 25 | 39 | 3/4" | 87.16.260 | MU0861007260 |
| 26 x 3 - 1" | 52 | 25 | 43 | 1" | 87.16.265 | MU0861010260 |
| 32 x 3 - 1" | 52 | 25 | 43 | 1" | 87.16.320 | MU0861010320 |
| 40 x 3,5 - 1 1/4" | 52 | 25 | 43 | 1" | 87.16.400 | MU0861012400 |
| 50 x 4 - 1 1/4" | 71 | 37 | 61 | 1 1/4" | 87.16.500 | MU0861012500 |
| 50 x 4 - 1 1/2" | 71 | 37 | 61 | 1 1/2" | 87.16.501 | MU0861015500 |

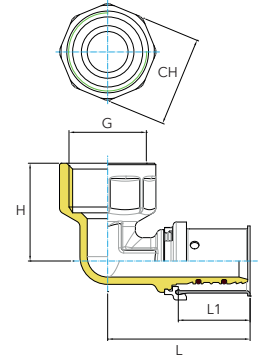

FEMALE ELBOW 90°
/ GOMITO 90° FEMMINA

862

| SIZE (mm) | L | L1 | H | G | CH | CODE | TECH. CODE |
|-------------------|----|----|----|--------|----|-----------|--------------|
| 14 x 2 - 1/2" | 47 | 25 | 25 | 1/2" | 25 | 87.17.140 | MU0862005140 |
| 16 x 2 - 1/2" | 54 | 25 | 33 | 1/2" | - | 87.17.159 | MU08620H5160 |
| 16 x 2 - 1/2" | 47 | 25 | 25 | 1/2" | 25 | 87.17.160 | MU0862005160 |
| 16 x 2,25 - 1/2" | 47 | 25 | 25 | 1/2" | 25 | 87.17.161 | MU0862005560 |
| 16 x 2 - 3/4" | 49 | 25 | 34 | 3/4" | 31 | 87.17.164 | MU0862007160 |
| 18 x 2 - 1/2" | 47 | 25 | 25 | 1/2" | 25 | 87.17.180 | MU0862005180 |
| 20 x 2 - 1/2" | 47 | 25 | 25 | 1/2" | 25 | 87.17.200 | MU0862005200 |
| 20 x 2 - 3/4" | 49 | 25 | 34 | 3/4" | 31 | 87.17.201 | MU0862007200 |
| 20 x 2,5 - 1/2" | 47 | 25 | 25 | 1/2" | 25 | 87.17.202 | MU0862005510 |
| 20 x 2,5 - 3/4" | 49 | 25 | 34 | 3/4" | 31 | 87.17.203 | MU0862007510 |
| 25 x 2,5 - 3/4" | 49 | 25 | 42 | 3/4" | 31 | 87.17.250 | MU0862007250 |
| 26 x 3 - 3/4" | 49 | 25 | 42 | 3/4" | 31 | 87.17.260 | MU0862007260 |
| 26 x 3 - 1" | 52 | 25 | 45 | 1" | 38 | 87.17.265 | MU0862010260 |
| 32 x 3 - 1" | 52 | 25 | 45 | 1" | 38 | 87.17.320 | MU0862010320 |
| 40 x 3,5 - 1 1/4" | 56 | 25 | 55 | 1 1/4" | 47 | 87.17.400 | MU0862012400 |
| 50 x 4 - 1 1/4" | 70 | 37 | 63 | 1 1/4" | - | 87.17.500 | MU0862012500 |
| 50 x 4 - 1 1/2" | 70 | 37 | 63 | 1 1/2" | - | 87.17.501 | MU0862015500 |



PRESS FITTINGS FOR MULTILAYER PIPE / RACCORDI A PRESSARE PER TUBO MULTISTRATO

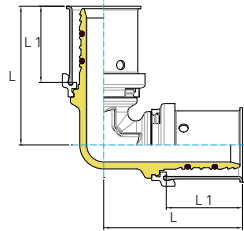

ELBOW 90°
/ GOMITO 90°

860

| SIZE (mm) | L | L1 | CODE | TECH. CODE |
|-----------|-----|----|------------------|--------------|
| 16 x 2 | 45 | 25 | 87.14.160 | MU0860000160 |
| 16 x 2,25 | 45 | 25 | 87.14.161 | MU0860000560 |
| 18 x 2 | 45 | 25 | 87.14.180 | MU0860000180 |
| 20 x 2 | 45 | 25 | 87.14.200 | MU0860000200 |
| 20 x 2,5 | 45 | 25 | 87.14.201 | MU0860000510 |
| 25 x 2,5 | 45 | 25 | 87.14.250 | MU0860000250 |
| 26 x 3 | 45 | 25 | 87.14.260 | MU0860000260 |
| 32 x 3 | 52 | 25 | 87.14.320 | MU0860000320 |
| 40 x 3,5 | 56 | 25 | 87.14.340 | MU0860000400 |
| 50 x 4 | 70 | 37 | 87.14.350 | MU0860000500 |
| 63 x 6 | 83 | 37 | 87.14.631 | MU0860000630 |
| 75 x 5 | 103 | 53 | - | MU0860000750 |

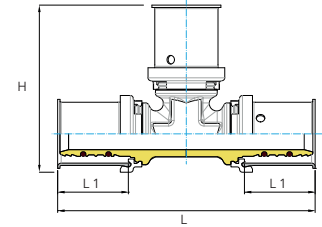

TEE
/ RACCORDO A T

850

| SIZE (mm) | L | L1 | H | CODE | TECH. CODE |
|-----------|-----|----|-----|------------------|--------------|
| 16 x 2 | 90 | 25 | 45 | 87.18.160 | MU0850000160 |
| 16 x 2,25 | 90 | 25 | 45 | 87.18.161 | MU0850000560 |
| 18 x 2 | 90 | 25 | 45 | 87.18.180 | MU0850000180 |
| 20 x 2 | 90 | 25 | 45 | 87.18.200 | MU0850000200 |
| 20 x 2,5 | 90 | 25 | 45 | 87.18.201 | MU0850000510 |
| 25 x 2,5 | 96 | 25 | 48 | 87.18.250 | MU0850000250 |
| 26 x 3 | 96 | 25 | 48 | 87.18.260 | MU0850000260 |
| 32 x 3 | 104 | 25 | 52 | 87.18.320 | MU0850000320 |
| 40 x 3,5 | 112 | 25 | 56 | 87.18.400 | MU0850000400 |
| 50 x 4 | 142 | 37 | 71 | 87.18.500 | MU0850000500 |
| 63 x 6 | 166 | 37 | 83 | 87.18.631 | MU0850000630 |
| 75 x 5 | 207 | 53 | 103 | - | MU0850000750 |



**PRESS FITTINGS FOR MULTILAYER PIPE
/ RACCORDI A PRESSARE PER TUBO MULTISTRATO**



TEE
/ RACCORDO A T

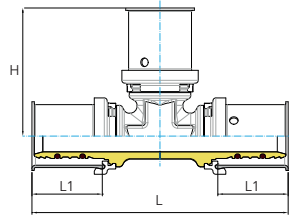

853

| SIZE (mm) | L | L1 | H | CODICE | TECH. CODE |
|------------------------------|-----|----------|----|------------------|--------------|
| 18 x 2 - 16 x 2 - 18 x 2 | 90 | 25 | 45 | 87.19.181 | MU085300CAC0 |
| 20 x 2 - 16 x 2 - 20 x 2 | 90 | 25 | 45 | 87.19.201 | MU085300BAB0 |
| 20 x 2 - 18 x 2 - 20 x 2 | 90 | 25 | 45 | 87.19.202 | MU085300BCB0 |
| 25 x 2,5 - 16 x 2 - 25 x 2,5 | 96 | 25 | 48 | 87.19.250 | MU085300GAG0 |
| 25 x 2,5 - 20 x 2 - 25 x 2,5 | 96 | 25 | 48 | 87.19.252 | MU085300GBG0 |
| 26 x 3 - 20 x 2,5 - 26 x 3 | 96 | 25 | 48 | 87.19.260 | MU085300DMD0 |
| 26 x 3 - 16 x 2 - 26 x 3 | 96 | 25 | 48 | 87.19.261 | MU085300DAD0 |
| 26 x 3 - 18 x 2 - 26 x 3 | 96 | 25 | 48 | 87.19.262 | MU085300DCD0 |
| 26 x 3 - 20 x 2 - 26 x 3 | 96 | 25 | 48 | 87.19.263 | MU085300DBD0 |
| 32 x 3 - 16 x 2 - 32 x 3 | 104 | 25 | 52 | 87.19.320 | MU085300EAE0 |
| 32 x 3 - 18 x 2 - 32 x 3 | 104 | 25 | 52 | 87.19.321 | MU085300ECE0 |
| 32 x 3 - 20 x 2 - 32 x 3 | 104 | 25 | 52 | 87.19.322 | MU085300EBE0 |
| 32 x 3 - 26 x 3 - 32 x 3 | 104 | 25 | 52 | 87.19.326 | MU085300EDE0 |
| 40 x 3,5 - 26 x 3 - 40 x 3,5 | 112 | 25 | 56 | 87.19.402 | MU085300HDH0 |
| 40 x 3,5 - 32 x 3 - 40 x 3,5 | 112 | 25 | 56 | 87.19.403 | MU085300HEH0 |
| 50 x 4 - 26 x 3 - 50 x 4 | 142 | 37-25 | 61 | 87.19.500 | MU085300IDI0 |
| 50 x 4 - 32 x 3 - 50 x 4 | 142 | 37-25 | 61 | 87.19.501 | MU085300IEI0 |
| 50 x 4 - 40 x 3,5 - 50 x 4 | 142 | 37-25 | 61 | 87.19.502 | MU085300IHI0 |
| 63 x 6 - 40 x 3,5 - 50 x 4 | 166 | 37-25-37 | 83 | - | MU085300NHIO |
| 63 x 6 - 40 x 3,5 - 63 x 6 | 166 | 37-25-37 | 83 | - | MU085300NHNO |
| 75 x 5 - 50 x 4 - 75 x 5 | 207 | 53-37 | 95 | - | MU085300PIPO |



TEE ENLARGED MIDDLE SECTION
/ RACCORDO A T ALLARGATO AL CENTRO

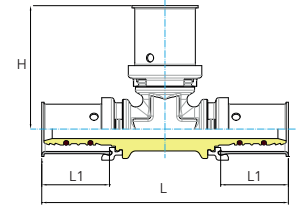

853

| SIZE (mm) | L | L1 | H | CODICE | TECH. CODE |
|--------------------------|-----|----|----|------------------|--------------|
| 14 x 2 - 16 x 2 - 14 x 2 | 90 | 25 | 45 | 87.21.140 | MU085300FAF0 |
| 16 x 2 - 20 x 2 - 16 x 2 | 90 | 25 | 45 | 87.21.161 | MU085300ABA0 |
| 20 x 2 - 26 x 3 - 20 x 2 | 96 | 25 | 48 | 87.21.201 | MU085300BDB0 |
| 26 x 3 - 32 x 3 - 26 x 3 | 104 | 25 | 52 | 87.21.260 | MU085300DED0 |



PRESS FITTINGS FOR MULTILAYER PIPE / RACCORDI A PRESSARE PER TUBO MULTISTRATO



REDUCING TEE
/ RACCORDO A T RIDOTTO

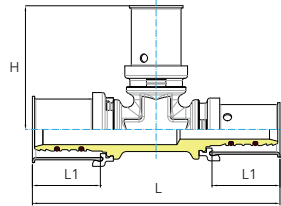

853

| SIZE (mm) | L | L1 | H | CODE | TECH. CODE |
|------------------------------|-----|-------|----|------------------|--------------|
| 18 x 2 - 16 x 2 - 16 x 2 | 90 | 25 | 45 | 87.20.181 | MU085300CAA0 |
| 20 x 2 - 16 x 2 - 16 x 2 | 90 | 25 | 45 | 87.20.202 | MU085300BAA0 |
| 20 x 2 - 18 x 2 - 18 x 2 | 90 | 25 | 45 | 87.20.203 | MU085300BCC0 |
| 20 x 2 - 16 x 2 - 18 x 2 | 90 | 25 | 45 | 87.20.204 | MU085300BAC0 |
| 20 x 2 - 20 x 2 - 16 x 2 | 90 | 25 | 45 | 87.20.206 | MU085300BBA0 |
| 20 x 2,5 - 16 x 2 - 16 x 2 | 90 | 25 | 45 | 87.20.209 | MU085300MAA0 |
| 26 x 3 - 16 x 2 - 16 x 2 | 96 | 25 | 48 | 87.20.259 | MU085300DAA0 |
| 26 x 3 - 16 x 2 - 20 x 2 | 96 | 25 | 48 | 87.20.260 | MU085300DAB0 |
| 26 x 3 - 18 x 2 - 18 x 2 | 96 | 25 | 48 | 87.20.262 | MU085300DCC0 |
| 26 x 3 - 20 x 2 - 16 x 2 | 96 | 25 | 48 | 87.20.264 | MU085300DBA0 |
| 26 x 3 - 20 x 2 - 20 x 2 | 96 | 25 | 48 | 87.20.265 | MU085300DBB0 |
| 26 x 3 - 20 x 2,5 - 20 x 2,5 | 96 | 25 | 48 | 87.20.267 | MU085300DMM0 |
| 26 x 3 - 26 x 3 - 16 x 2 | 96 | 25 | 48 | 87.20.269 | MU085300DDA0 |
| 26 x 3 - 26 x 3 - 20 x 2 | 96 | 25 | 48 | 87.20.270 | MU085300DDB0 |
| 32 x 3 - 20 x 2 - 26 x 3 | 104 | 25 | 52 | 87.20.320 | MU085300EBD0 |
| 32 x 3 - 26 x 3 - 26 x 3 | 104 | 25 | 52 | 87.20.325 | MU085300EDD0 |
| 32 x 3 - 32 x 3 - 16 x 2 | 104 | 25 | 52 | - | MU085300EEA0 |
| 32 x 3 - 32 x 3 - 20 x 2 | 104 | 25 | 52 | 87.20.326 | MU085300EEB0 |
| 32 x 3 - 32 x 3 - 26 x 3 | 104 | 25 | 52 | 87.20.329 | MU085300EED0 |
| 40 x 3,5 - 32 x 3 - 32 x 3 | 112 | 25 | 56 | 87.20.400 | MU085300HEE0 |
| 40 x 3,5 - 26 x 3 - 32 x 3 | 112 | 25 | 56 | 87.20.403 | MU085300HDE0 |
| 40 x 3,5 - 40 x 3,5 - 26 x 3 | 112 | 25 | 56 | 87.20.404 | MU085300HHD0 |
| 40 x 3,5 - 40 x 3,5 - 32 x 3 | 112 | 25 | 56 | 87.20.405 | MU085300HHE0 |
| 50 x 4 - 40 x 3,5 - 40 x 3,5 | 132 | 37-25 | 61 | 87.20.500 | MU085300IHH0 |
| 50 x 4 - 32 x 3 - 40 x 3,5 | 132 | 37-25 | 61 | 87.20.501 | MU085300IEH0 |
| 50 x 4 - 50 x 4 - 32 x 3 | 132 | 37-25 | 71 | 87.20.502 | MU085300IIE0 |
| 50 x 4 - 50 x 4 - 40 x 3,5 | 132 | 37-25 | 71 | 87.20.503 | MU085300IIH0 |
| 63 x 6 - 40 x 3,5 - 50 x 4 | | | | | MU085300NHIO |



FEMALE TEE
/ RACCORDO A T FEMMINA

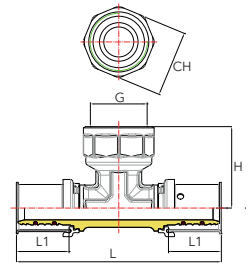

852

| SIZE (mm) | L | L1 | H | G | CH | CODICE | TECH. CODE |
|----------------------|-----|----|----|--------|----|------------------|--------------|
| 16x2-1/2"-16x2 | 92 | 25 | 33 | 1/2" | 25 | 87.23.160 | MU0852005160 |
| 16x2,25-1/2"-16x2,25 | 92 | 25 | 33 | 1/2" | 25 | 87.23.161 | MU0852005560 |
| 18x2-1/2"-18x2 | 92 | 25 | 35 | 1/2" | 25 | 87.23.180 | MU0852005180 |
| 20x2-1/2"-20x2 | 92 | 25 | 35 | 1/2" | 25 | 87.23.200 | MU0852005200 |
| 20x2-3/4"-20x2 | 96 | 25 | 38 | 3/4" | 31 | 87.23.201 | MU0852007200 |
| 20x2,5-1/2"-20x2,5 | 92 | 25 | 35 | 1/2" | 25 | 87.23.202 | MU0852005510 |
| 25x2,5-1/2"-25x2,5 | 94 | 25 | 37 | 1/2" | 25 | 87.23.250 | MU0852005250 |
| 25x2,5-3/4"-25x2,5 | 98 | 25 | 38 | 3/4" | 31 | 87.23.252 | MU0852007250 |
| 26x3-1/2"-26x3 | 94 | 25 | 37 | 1/2" | 25 | 87.23.260 | MU0852005260 |
| 26x3-3/4"-26x3 | 98 | 25 | 38 | 3/4" | 31 | 87.23.263 | MU0852007260 |
| 32x3-1/2"-32x3 | 104 | 25 | 50 | 1/2" | 38 | 87.23.320 | MU0852005320 |
| 32x3-3/4"-32x3 | 104 | 25 | 50 | 3/4" | 38 | 87.23.321 | MU0852007320 |
| 32x3-1"-32x3 | 104 | 25 | 45 | 1/2" | 38 | 87.23.322 | MU0852010320 |
| 32x3-1 1/4"-32x3 | 112 | 25 | 55 | 1 1/2" | 47 | 87.23.323 | MU0852012320 |
| 40x3,5-1"-40x3,5 | 112 | 25 | 55 | 1" | 47 | 87.23.400 | MU0852010400 |
| 40x3,5-1 1/4"-40x3,5 | 112 | 25 | 55 | 1 1/4" | 47 | 87.23.401 | MU0852012400 |
| 50x4-1 1/4"-50x4 | 142 | 37 | 63 | 1 1/4" | | 87.23.500 | MU0852012500 |
| 50x4-1 1/2"-50x4 | 142 | 37 | 63 | 1/2" | | 87.23.501 | MU0852015500 |
| 63x6-1"-63x6 | 168 | 37 | 60 | 1" | | 87.23.631 | MU0852010630 |
| 63x6-1 1/2"-63x6 | 168 | 37 | 60 | 1 1/2" | | 87.23.632 | MU0852015630 |



**PRESS FITTINGS FOR MULTILAYER PIPE
/ RACCORDI A PRESSARE PER TUBO MULTISTRATO**

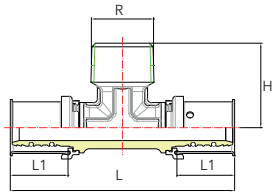

**MALE TEE
/ RACCORDO A T MASCHIO**

851

| SIZE (mm) | L | L1 | H | R | CODE | TECH. CODE |
|----------------------------|-----|----|----|------|-----------|--------------|
| 16 x 2 - 1/2" - 16 x 2 | 92 | 25 | 29 | 1/2" | 87.22.160 | MU0851005160 |
| 18 x 2 - 1/2" - 18 x 2 | 92 | 25 | 32 | 1/2" | 87.22.180 | MU0851005180 |
| 20 x 2 - 1/2" - 20 x 2 | 92 | 25 | 32 | 1/2" | 87.22.200 | MU0851005200 |
| 20 x 2 - 3/4" - 20 x 2 | 98 | 25 | 36 | 3/4" | 87.22.201 | MU0851007200 |
| 25 x 2,5 - 3/4" - 25 x 2,5 | 98 | 25 | 36 | 3/4" | 87.22.251 | MU0851007250 |
| 25 x 2,5 - 1" - 25 x 2,5 | 104 | 25 | 40 | 1" | 87.22.252 | MU0851010250 |
| 26 x 3 - 1/2" - 26 x 3 | 98 | 25 | 33 | 1/2" | 87.22.260 | MU0851005260 |
| 26 x 3 - 3/4" - 26 x 3 | 98 | 25 | 36 | 3/4" | 87.22.261 | MU0851007260 |
| 26 x 3 - 1" - 26 x 3 | 104 | 25 | 40 | 1" | 87.22.262 | MU0851010260 |
| 32 x 3 - 3/4" - 32 x 3 | 104 | 25 | 40 | 3/4" | 87.22.320 | MU0851007320 |
| 32 x 3 - 1" - 32 x 3 | 104 | 25 | 40 | 1" | 87.22.321 | MU0851010320 |

**ELBOW 45°
/ GOMITO 45°**

866

| SIZE (mm) | L | L1 | CODE | TECH. CODE |
|-----------|----|----|-----------|--------------|
| 26 x 3 | 56 | 25 | 87.30.260 | MU0866000260 |
| 32 x 3 | 56 | 25 | 87.30.320 | MU0866000320 |
| 40 x 3,5 | 56 | 25 | 87.30.400 | MU0866000400 |
| 50 x 4 | 77 | 37 | 87.30.500 | MU0866000500 |

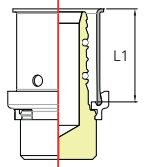
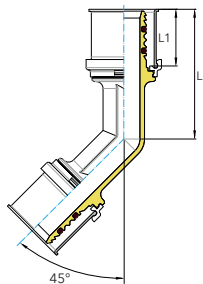

**STOP END
/ TAPPO CIECO**

881

| SIZE (mm) | L1 | CODE | TECH. CODE |
|-----------|----|-----------|--------------|
| 14 x 2 | 25 | 87.31.140 | MU0881000140 |
| 16 x 2 | 25 | 87.31.160 | MU0881000160 |
| 18 x 2 | 25 | 87.31.180 | MU0881000180 |
| 20 x 2 | 25 | 87.31.200 | MU0881000200 |
| 25 x 2,5 | 25 | 87.31.250 | MU0881000250 |
| 26 x 3 | 25 | 87.31.260 | MU0881000260 |
| 32 x 3 | 25 | 87.31.320 | MU0881000320 |
| 40 x 3,5 | 25 | 87.31.400 | MU0881000400 |
| 50 x 4 | 37 | 87.31.500 | MU0881000500 |

3 FIXING HOLES

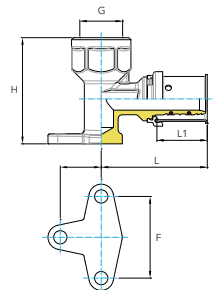

**WALLPLATE ELBOW 90°
/ GOMITO 90° FLANGIATO**

863

| SIZE (mm) | L | L1 | H | G | CH | F | CODE | TECH. CODE |
|------------------|----|----|----|------|----|----|-----------|---------------|
| 14 x 2 - 1/2" | 52 | 25 | 52 | 1/2" | 26 | 40 | 87.24.140 | MU08630005140 |
| 16 x 2 - 3/8" | 47 | 25 | 39 | 3/8" | 25 | 40 | 87.24.145 | MU08630003160 |
| 16 x 2,25 - 1/2" | 47 | 25 | 39 | 1/2" | 25 | 40 | 87.24.159 | MU08630005560 |
| 16 x 2 - 1/2" | 47 | 25 | 39 | 1/2" | 25 | 40 | 87.24.160 | MU08630005160 |
| 16 x 2 - 1/2" | 52 | 25 | 52 | 1/2" | 26 | 40 | 87.24.161 | MU08630H5160 |
| 18 x 2 - 1/2" | 52 | 25 | 52 | 1/2" | 26 | 40 | 87.24.180 | MU08630005180 |
| 20 x 2 - 1/2" | 52 | 25 | 52 | 1/2" | 26 | 40 | 87.24.200 | MU08630005200 |
| 20 x 2 - 3/4" | 52 | 25 | 52 | 3/4" | 30 | 40 | 87.24.201 | MU08630007200 |
| 20 x 2,5 - 1/2" | 52 | 25 | 52 | 1/2" | 26 | 40 | 87.24.202 | MU08630005510 |
| 20 x 2,5 - 3/4" | 52 | 25 | 52 | 3/4" | 30 | 40 | 87.24.203 | MU08630007510 |
| 25 x 2,5 - 3/4" | 52 | 25 | 52 | 3/4" | 30 | 40 | 87.24.250 | MU08630007250 |
| 26 x 3 - 3/4" | 52 | 25 | 52 | 3/4" | 30 | 40 | 87.24.260 | MU08630007260 |



PRESS FITTINGS FOR MULTILAYER PIPE / RACCORDI A PRESSURE PER TUBO MULTISTRATO



WALLPLATE ELBOW-LONG 90°
/GOMITO 90° FLANGIATO LUNGO

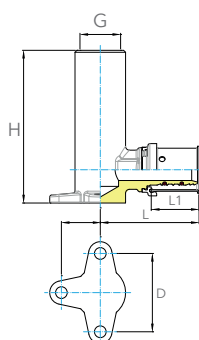

863L

| SIZE (mm) | L | L1 | H | G | D | CODE | TECH. CODE |
|-----------|----|----|----|------|----|-----------|--------------|
| 16x2-1/2" | 51 | 25 | 78 | 1/2" | 40 | 87.26.160 | MU0863L05160 |
| 20x2-1/2" | 51 | 25 | 78 | 1/2" | 40 | 87.26.200 | MU0863L05200 |



WALLPLATE ELBOW FOR SERIES CONNECTIONS
/ ATTACCO FLANGIATO PASSANTE PER COLLEGAMENTI IN SERIE

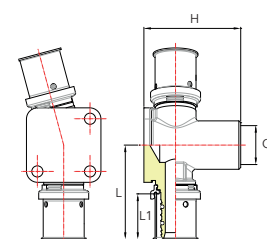

865

| SIZE (mm) | L | L1 | H | G | CODE | TECH. CODE |
|------------------|----|----|----|------|-----------|--------------|
| 16x2-1/2" - 16x2 | 51 | 25 | 52 | 1/2" | 87.26.205 | MU0865005160 |
| 20x2-1/2" - 20x2 | 51 | 25 | 52 | 1/2" | 87.26.210 | MU0865005200 |



TEE DISALIGNED FITTING FEMALE
/RACCORDO A FEMMINA DISASSATO

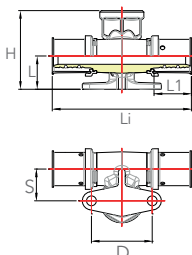

891

| SIZE (mm) | H | L | L1 | Li | S | D | CODE | TECH. CODE |
|------------------|----|----|----|----|----|----|-----------|--------------|
| 16x2-1/2" - 16x2 | 52 | 22 | 25 | 92 | 21 | 40 | 87.54.032 | MU0891005160 |
| 20x2-1/2" - 20x2 | 52 | 22 | 25 | 92 | 21 | 40 | 87.54.033 | MU0891005200 |



WALLPLATE ELBOW-DOUBLE 90°
/GOMITO 90° FLANGIATO DOPPIO

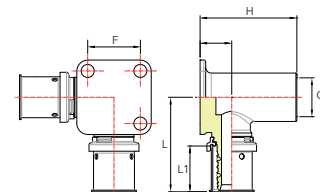

864

| SIZE (mm) | L | L1 | H | G | F | CODE | TECH. CODE |
|------------------|----|----|----|------|----|-----------|--------------|
| 16x2-1/2" - 16x2 | 51 | 25 | 52 | 1/2" | 28 | 87.25.160 | MU0864005160 |
| 20x2-1/2" - 20x2 | 51 | 25 | 52 | 1/2" | 28 | 87.25.200 | MU0864005200 |



WALLPLATE ELBOW U-SHAPED 90°
/ GOMITO 90° FLANGIATO AD U

887

| SIZE (mm) | L | L1 | H | G | D | CODE | TECH. CODE |
|------------------|----|----|----|------|----|-----------|--------------|
| 16x2-1/2" - 16x2 | 54 | 25 | 35 | 1/2" | 50 | 87.27.160 | MU0887005160 |
| 20x2-1/2" - 20x2 | 54 | 25 | 35 | 1/2" | 50 | 87.27.200 | MU0887005200 |

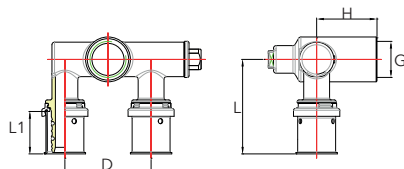

WALLPLATE ELBOW U-SHAPED 180°
/ GOMITO FLANGIATO AD U 180°

884

| SIZE (mm) | L | L1 | H | F | D | CODE | TECH. CODE |
|-----------|----|----|----|----|----|-----------|--------------|
| 16x2-1/2" | 78 | 25 | 52 | 40 | 50 | 87.27.216 | MU0884005160 |
| 20x2-1/2" | 78 | 25 | 52 | 40 | 50 | 87.27.220 | MU0884005200 |

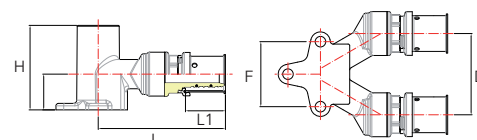



PRESS FITTINGS FOR MULTILAYER PIPE / RACCORDI A PRESSARE PER TUBO MULTISTRATO

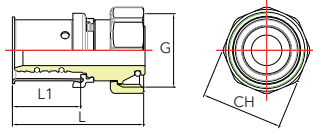

CONNECTING SCREW FITTING WITH SWIVEL NUT AND EUROCONO
/ RACCORDO DIRITTO DADO PRIGIONIERO CON TENUTA EUROCONO

875

| SIZE (mm) | L | L1 | G | CH | CODE | TECH. CODE |
|---------------|----|----|------|----|------------------|----------------|
| 16 x 2 - 3/4" | 48 | 25 | 3/4" | 30 | 87.39.160 | MU087500716L |
| 18 x 2 - 3/4" | 48 | 25 | 3/4" | 30 | 87.39.180 | MU087500718L |
| 20 x 2 - 3/4" | 48 | 25 | 3/4" | 30 | 87.39.200 | MU087500720L |
| 26 x 3 - 1" | 44 | 25 | 1" | 37 | 87.39.260 | MU087501026L |
| 32 x 3 - 1" | 57 | 25 | 1" | 37 | 87.39.265 | MU087501032L |
| 26 x 3 - 3/4" | 52 | 25 | 3/4" | 31 | - | MU087500726L • |

• WITH ADAPTOR AND GASKET
/ CON ADATTATORE E GUARNIZIONE

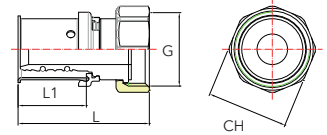

CONNECTING STRAIGHT SCREW FITTING WITH FLAT SEAL WITH WASHER
/ RACCORDO DIRITTO TENUTA PIATTA CON GUARNIZIONE

876

| SIZE (mm) | L | L1 | G | CH | CODE | TECH. CODE |
|-------------------|-----|----|--------|----|------------------|--------------|
| 16 x 2 - 3/8" | 48 | 25 | 3/8" | 19 | 87.42.140 | MU087600316L |
| 16 x 2 - 1/2" | 49 | 25 | 1/2" | 24 | 87.42.150 | MU087600516L |
| 16 x 2 - 3/4" | 47 | 25 | 3/4" | 30 | 87.42.160 | MU087600716L |
| 20 x 2 - 1/2" | 57 | 25 | 1/2" | 25 | 87.42.170 | MU087600520L |
| 18 x 2 - 3/4" | 47 | 25 | 3/4" | 30 | 87.42.180 | MU087600718L |
| 20 x 2 - 3/4" | 47 | 25 | 3/4" | 30 | 87.42.200 | MU087600720L |
| 26 x 3 - 1" | 54 | 25 | 1" | 37 | 87.42.260 | MU087601026L |
| 26 x 3 - 3/4" | 62 | 25 | 3/4" | 31 | - | MU087600726L |
| 32 x 3 - 1" | 63 | 25 | 1" | 38 | - | MU087601032L |
| 32 x 3 - 1 1/4" | 52 | 25 | 1 1/4" | 46 | - | MU087601232L |
| 40 x 3,5 - 1 1/4" | 63 | 25 | 1 1/4" | 45 | - | MU0876012400 |
| 50 x 4 - 1 1/2" | 80 | 25 | 1 1/2" | 52 | - | MU0876015500 |
| 63 x 6 - 2" | 97 | 25 | 2" | 64 | - | MU0876020630 |
| 75 x 5 - 2 1/2" | 118 | 25 | 2 1/2" | 80 | - | MU0876025750 |

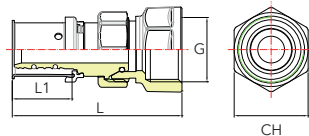

FEMALE STRAIGHT SCREW FITTING - CONICAL
/ RACCORDO DIRITTO SCOMPONIBILE FEMMINA TENUTA CONICA

883

| SIZE (mm) | L | L1 | G | CH | CODE | TECH. CODE |
|---------------|----|----|------|----|------------------|--------------|
| 16 x 2 - 1/2" | 67 | 25 | 1/2" | 26 | 87.36.160 | MU0883005160 |
| 16 x 2 - 3/4" | 72 | 25 | 3/4" | 31 | 87.36.161 | MU0883007160 |
| 20 x 2 - 1/2" | 67 | 25 | 1/2" | 26 | 87.36.200 | MU0883005200 |
| 20 x 2 - 3/4" | 72 | 25 | 3/4" | 31 | 87.36.201 | MU0883007200 |
| 26 x 3 - 3/4" | 73 | 25 | 3/4" | 38 | 87.36.260 | MU0883007260 |
| 26 x 3 - 1" | 73 | 25 | 1" | 38 | 87.36.261 | MU0883010260 |
| 32 x 3 - 1" | 86 | 25 | 1" | 38 | 87.36.320 | MU0883010320 |

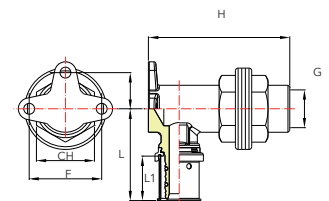

ELBOW MALE/FEMALE LONG FOR CONNECTION TO LAVATORY FLUSH-WATER TANK
/ GOMITO FLANGIATO MASCHIO/FEMMINA LUNGO PER CASSETTA DI RISCIACQUO

867

| SIZE (mm) | L | L1 | H | G | CH | F | CODE | TECH. CODE |
|-----------|----|----|----|------|----|----|------------------|--------------|
| 16 x 2 | 51 | 25 | 78 | 1/2" | 30 | 40 | 87.33.105 | MU0867005160 |
| 20 x 2 | 51 | 25 | 78 | 1/2" | 30 | 40 | 87.33.115 | MU0867005200 |

PRESS FITTINGS FOR MULTILAYER PIPE / RACCORDI A PRESSARE PER TUBO MULTISTRATO

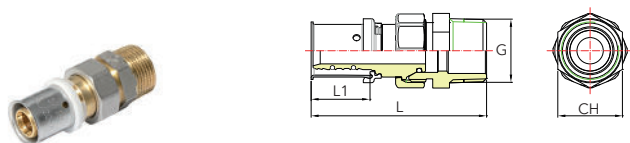

MALE STRAIGHT SCREW FITTING CONICAL
/ RACCORDO DIRITTO SCOMPONIBILE MASCHIO TENUTA CONICA

873

| SIZE (mm) | L | L1 | R | CH | CODE | TECH. CODE |
|---------------|----|----|------|----|------------------|--------------|
| 16 x 2 - 1/2" | 73 | 25 | 1/2" | 26 | 87.37.160 | MU0873005160 |
| 16 x 2 - 3/4" | 74 | 25 | 3/4" | 27 | 87.37.161 | MU0873007160 |
| 20 x 2 - 1/2" | 73 | 25 | 1/2" | 26 | 87.37.200 | MU0873005200 |
| 20 x 2 - 3/4" | 74 | 25 | 3/4" | 27 | 87.37.201 | MU0873007200 |
| 26 x 3 - 3/4" | 67 | 25 | 3/4" | 33 | 87.37.260 | MU0873007260 |
| 26 x 3 - 1" | 71 | 25 | 1" | 33 | 87.37.261 | MU0873010260 |
| 32 x 3 - 1" | 85 | 25 | 1" | 33 | 87.37.320 | MU0873010320 |

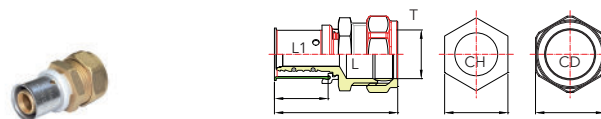

STRAIGHT PRESS FITTING COUPLER FOR COPPER PIPE CONNECTION
/ RACCORDO A PRESSARE DIRITTO PER TUBO RAME

877

| SIZE (mm) | L | L1 | T | CD | CH | CODE | TECH. CODE |
|----------------|----|----|----|----|----|------------------|--------------|
| 16 x 2 - 15 mm | 54 | 25 | 15 | 24 | 22 | 87.47.020 | MU0877016150 |
| 20 x 2 - 22 mm | 54 | 25 | 22 | 32 | 29 | 87.47.030 | MU0877020220 |
| 26 x 3 - 22 mm | 54 | 25 | 22 | 32 | 29 | 87.47.035 | MU0877026220 |
| 26 x 3 - 28 mm | 59 | 25 | 28 | 38 | 35 | 87.47.040 | MU0877026280 |



MALE ELBOW SCREW CONNECTOR 90° TAPER THREAD
/ GOMITO 90° SCOMPONIBILE MASCHIO TENUTA CONICA

868

| SIZE (mm) | L | L1 | H | R | CODE | TECH. CODE |
|---------------|----|----|----|------|------------------|--------------|
| 16 x 2 - 1/2" | 68 | 25 | 30 | 1/2" | 87.34.160 | MU0868005160 |
| 20 x 2 - 1/2" | 68 | 25 | 30 | 1/2" | 87.34.200 | MU0868005200 |
| 20 x 2 - 3/4" | 68 | 25 | 30 | 1/2" | 87.34.201 | MU0868007200 |

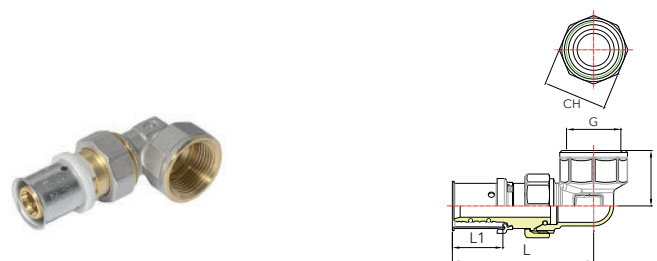

FEMALE ELBOW SCREW CONNECTOR 90° TAPER THREAD
/ GOMITO 90° SCOMPONIBILE FEMMINA TENUTA CONICA

869

| SIZE (mm) | L | L1 | H | G | CH | CODE | TECH. CODE |
|---------------|----|----|----|------|----|------------------|--------------|
| 16 x 2 - 1/2" | 68 | 25 | 27 | 1/2" | 25 | 87.35.160 | MU0869005160 |
| 20 x 2 - 1/2" | 68 | 25 | 27 | 1/2" | 25 | 87.35.200 | MU0869005200 |
| 20 x 2 - 3/4" | 68 | 25 | 30 | 3/4" | 31 | 87.35.201 | MU0869007200 |



**PRESS FITTINGS FOR MULTILAYER PIPE
/ RACCORDI A PRESSARE PER TUBO MULTISTRATO**



PRESS ELBOW WITH SWIVEL NUT
/ GOMITO A PRESSARE CON DADO GIREVOLE

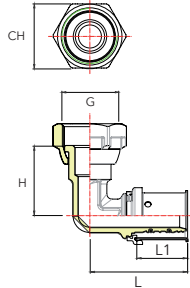

892

| SIZE (mm) | L | L1 | H | G | CH | CODE | TECH. CODE |
|---------------|----|----|----|------|----|------|--------------|
| 16 x 2 - 3/8" | 46 | 25 | 28 | 3/8" | 19 | - | MU0892003160 |
| 16 x 2 - 1/2" | 46 | 25 | 33 | 1/2" | 25 | - | MU0892005160 |
| 16 x 2 - 3/4" | 46 | 25 | 33 | 3/4" | 31 | - | MU0892007160 |
| 20 x 2 - 1/2" | 46 | 25 | 33 | 1/2" | 25 | - | MU0892005200 |
| 20 x 2 - 3/4" | 47 | 25 | 33 | 3/4" | 31 | - | MU0892007200 |
| 26 x 3 - 3/4" | 48 | 25 | 38 | 3/4" | 31 | - | MU0892007260 |
| 26 x 3 - 1" | 48 | 25 | 38 | 1" | 37 | - | MU0892010260 |



ELBOW PRESS FOR COPPER PIPE CONNECTION
/ GOMITO A PRESSARE PER TUBO RAME

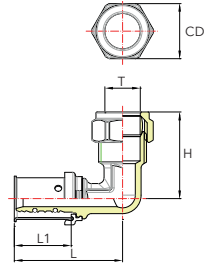

858

| SIZE (mm) | L | L1 | H | T | CD | CODE | TECH. CODE |
|----------------|----|----|----|----|----|------------------|--------------|
| 16 x 2 - 15 mm | 53 | 25 | 38 | 15 | 24 | 87.47.115 | MU0858016150 |



**ELBOW FEMALE FOR CONNECTION
TO LAVATORY FLUSH-WATER TANK**
/ GOMITO FLANGIATO FEMMINA
PER CASSETTA DI RISCIAQUO

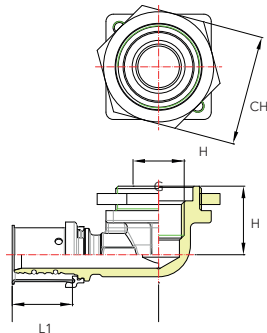

856

| SIZE (mm) | L | L1 | H | G | CH | CODE | TECH. CODE |
|---------------|----|----|----|------|----|------------------|--------------|
| 16 x 2 - 1/2" | 60 | 25 | 28 | 1/2" | 45 | 87.28.160 | MU0856005160 |
| 20 x 2 - 1/2" | 60 | 25 | 28 | 1/2" | 45 | 87.28.200 | MU0856005200 |



**TEE FEMALE FOR CONNECTION
TO LAVATORY FLUSH-WATER TANK**
/ RACCORDO A T FLANGIATO FEMMINA
PER CASSETTA DI RISCIAQUO

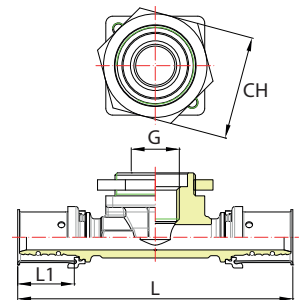

857

| SIZE (mm) | L | L1 | H | G | CH | CODE | TECH. CODE |
|------------------------|-----|----|----|------|----|------------------|--------------|
| 16 x 2 - 1/2" - 16 x 2 | 120 | 25 | 28 | 1/2" | 45 | 87.29.160 | MU0857005160 |
| 20 x 2 - 1/2" - 20 x 2 | 120 | 25 | 28 | 1/2" | 45 | 87.29.200 | MU0857005200 |



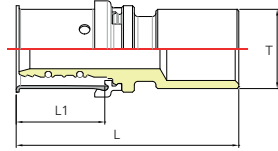

PRESS FITTINGS FOR MULTILAYER PIPE / RACCORDI A PRESSARE PER TUBO MULTISTRATO



NIPPLES PRESS WITH INSERT

/ RACCORDO A PRESSARE DIRITTO CON INSERTO

886

| SIZE (mm) | L | L1 | T | CODE | TECH. CODE |
|--|----|----|----|-----------|--------------|
| 16 x 2 - 12 mm | 57 | 25 | 12 | 87.47.055 | MU0886016120 |
| 16 x 2 - 15 mm | 60 | 25 | 15 | 87.47.060 | MU0886016150 |
| 20 x 2 - 22 mm | 62 | 25 | 22 | 87.47.070 | MU0886020220 |
|  20 x 2 - 22 mm | 63 | 25 | 22 | 87.47.080 | MU0886120220 |
|  26 x 3 - 22 mm | 62 | 25 | 22 | 87.47.081 | MU0886126220 |
| 26 x 3 - 22 mm | 62 | 25 | 22 | - | MU0886026220 |
|  32 x 3 - 28 mm | 66 | 25 | 28 | 87.47.082 | MU0886132280 |
| 32 x 3 - 28 mm | 66 | 25 | 28 | - | MU0886032280 |

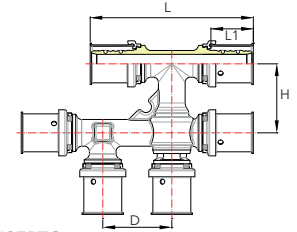

NIPPLES PRESS WITH INSERT

/ RACCORDO A PRESSARE DIRITTO CON INSERTO

888

| SIZE (mm) | L | L1 | H | D | CODE | TECH. CODE |
|--------------|----|----|----|----|-----------|--------------|
| 16 x 16 x 16 | 95 | 25 | 40 | 40 | 87.49.010 | MU0888000160 |
| 20 x 16 x 16 | 95 | 25 | 40 | 40 | 87.49.015 | MU088800BAA0 |
| 20 x 16 x 20 | 95 | 25 | 40 | 40 | 87.49.020 | MU088800BAB0 |
| 20 x 20 x 20 | 95 | 25 | 40 | 40 | 87.49.025 | MU0888000200 |



**PRESS FITTINGS FOR MULTILAYER PIPE
/ RACCORDI A PRESSARE PER TUBO MULTISTRATO**



**ELBOW CONNECTOR
FOR RADIATORS NICKEL PLATED
/ GOMITO PER RADIATORI NICHELATO**

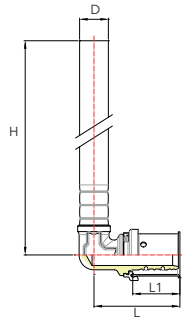

885 total length 300 mm

| SIZE (mm) | L | L1 | H | D | CODE | TECH. CODE |
|----------------|----|----|-----|----|------------------|--------------|
| 14 x 2 - 15 mm | 45 | 25 | 300 | 15 | 87.45.140 | MU088500014N |
| 16 x 2 - 15 mm | 45 | 25 | 300 | 15 | 87.45.160 | MU088500016N |
| 18 x 2 - 15 mm | 45 | 25 | 300 | 15 | 87.45.180 | MU088500018N |
| 20 x 2 - 15 mm | 45 | 25 | 300 | 15 | 87.45.200 | MU088500020N |

885 total length 1100 mm

| SIZE (mm) | L | L1 | H | D | CODE | TECH. CODE |
|----------------|----|----|------|----|------------------|--------------|
| 16 x 2 - 15 mm | 45 | 25 | 1100 | 15 | 87.45.161 | MU088500116N |



**TEE CONNECTOR FOR RADIATORS
NICKEL PLATED
RACCORDO A T PER RADIATORI
NICHELATO**

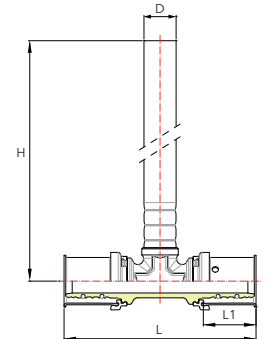

889 total length 300 mm

| SIZE (mm) | L | L1 | H | D | CODE | TECH. CODE |
|----------------|----|----|-----|----|------------------|--------------|
| 16 x 2 - 15 mm | 90 | 25 | 300 | 15 | 87.46.160 | MU088900016N |
| 20 x 2 - 15 mm | 90 | 25 | 300 | 15 | 87.46.200 | MU088900020N |

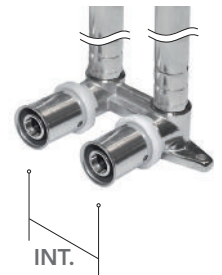

**DOUBLE PRESS ELBOW
WITH COPPER PIPE NICKEL PLATED
/ RACCORDO DOPPIO A PRESSARE
CON TUBO RAME NICHELATO**

890

| SIZE (mm) | INT. | CODE | TECH. CODE |
|----------------|---------|------------------|--------------|
| 15 mm - 16 x 2 | 37,5 mm | 87.46.250 | MU089000016N |
| 15 mm - 16 x 2 | 50 mm | | MU089005016N |

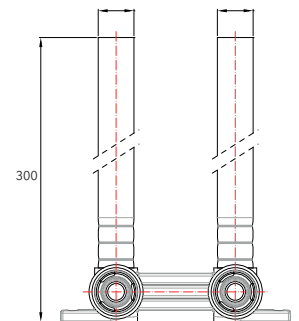
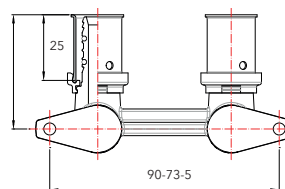



PRESS FITTINGS FOR MULTILAYER PIPE / RACCORDI A PRESSARE PER TUBO MULTISTRATO



**MOUNTING PLATE ASSEMBLED WITH 2 WALLPLATE ELBOWS 90°
DISTANCE 76 mm**

STAFFA DI FISSAGGIO ASSEMBLATA CON 2 GOMITI FLANGIATI FEMMINA 90° INTERASSE 76 mm

834

| SIZE (mm) | CODE | TECH. CODE |
|---------------|-----------|--------------|
| 16 x 2 - 1/2" | 87.54.060 | MU0834005160 |

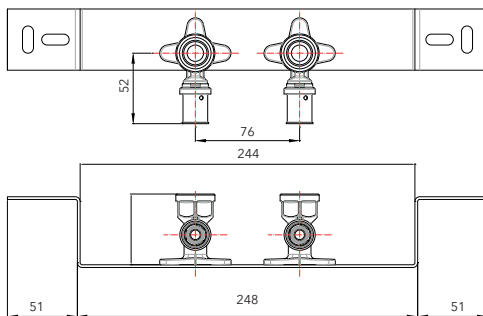

**MOUNTING PLATE ASSEMBLED WITH 2 WALLPLATE ELBOWS 90° FEMALE
WITH SOUNDPROOF ELEMENTS, DISTANCE 153 mm**

/ STAFFA DI FISSAGGIO ASSEMBLATA CON 2 GOMITI FLANGIATI FEMMINA 90° CON ISOLANTI ANTI RUMORE INTERASSE 153 mm

833

| SIZE (mm) | CODE | TECH. CODE |
|---------------|-----------|--------------|
| 16 x 2 - 1/2" | 87.54.030 | MU0833005160 |

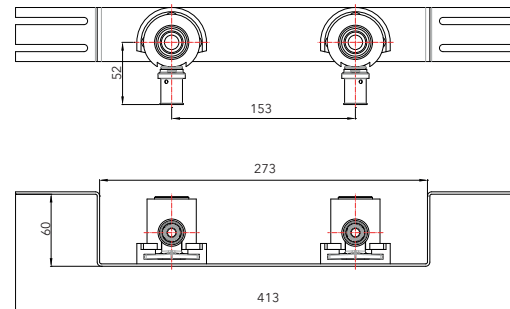

**MOUNTING PLATE ASSEMBLED WITH 2 WALLPLATE ELBOWS 90°
DISTANCE 152 mm**

/ STAFFA DI FISSAGGIO ASSEMBLATA CON 2 GOMITI FLANGIATI FEMMINA 90° INTERASSE 152 mm

835

| SIZE (mm) | CODE | TECH. CODE |
|---------------|-----------|--------------|
| 16 x 2 - 1/2" | 87.54.065 | MU0835005160 |
| 20 x 2 - 1/2" | 87.54.066 | MU0835005200 |

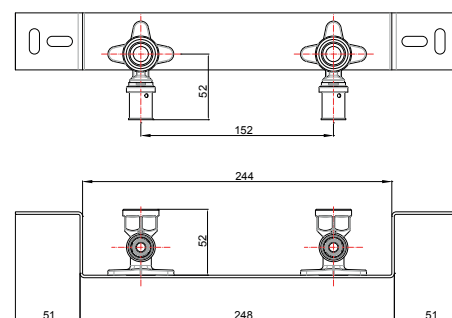



**PRESS FITTINGS FOR MULTILAYER PIPE
/ RACCORDI A PRESSARE PER TUBO MULTISTRATO**

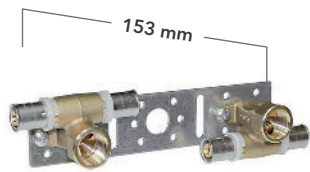

MOUNTING PLATE ASSEMBLED WITH 2 DISALIGNED TEE FITTINGS

STAFFA DI FISSAGGIO ASSEMBLATA CON 2 RACCORDI A T DISASSATI

830

| SIZE (mm) | CODE | TECH. CODE |
|------------------------|------------------|--------------|
| 16 x 2 - 1/2" - 16 x 2 | 87.54.034 | MU0830005160 |
| 20 x 2 - 1/2" - 20 x 2 | 87.54.035 | MU0830005200 |

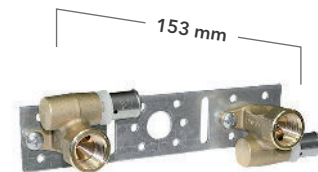
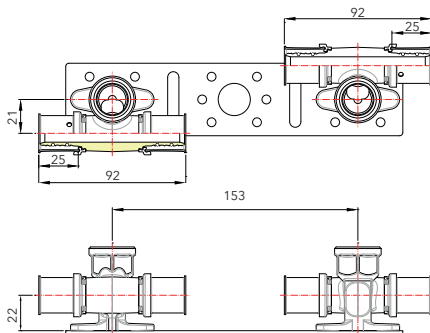

MOUNTING PLATE ASSEMBLED WITH 2 DISALIGNED END FITTINGS

STAFFA DI FISSAGGIO ASSEMBLATA CON 2 RACCORDI DISASSATI

831

| SIZE (mm) | CODE | TECH. CODE |
|------------------------|------------------|--------------|
| 16 x 2 - 1/2" - 16 x 2 | 87.54.039 | MU0831005160 |
| 20 x 2 - 1/2" - 20 x 2 | 87.54.040 | MU0831005200 |

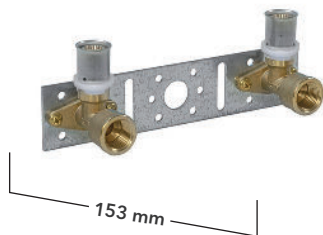
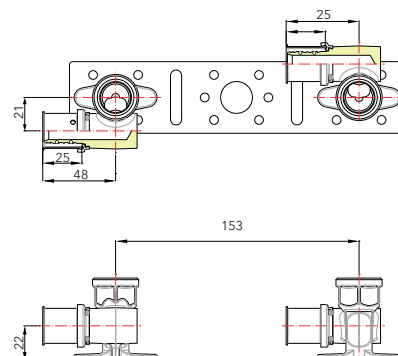

MOUNTING PLATE ASSEMBLED WITH 2 WALLPLATE ELBOWS 90° FEMALE, DISTANCE 153 mm

STAFFA DI FISSAGGIO ASSEMBLATA CON 2 GOMITI FLANGIATI FEMMINA 90°, INTERASSE 153 mm

832

| SIZE (mm) | CODE | TECH. CODE |
|---------------|------------------|--------------|
| 16 x 2 - 1/2" | 87.54.005 | MU0832005160 |
| 20 x 2 - 1/2" | 87.54.019 | MU0832005200 |
| 20 x 2 - 3/4" | 87.54.020 | MU0832007200 |

PRESS FITTINGS FOR MULTILAYER PIPE / RACCORDI A PRESSURE PER TUBO MULTISTRATO

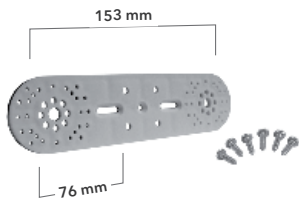

MOUNTING PLATE WITH 6 SCREWS

/ STAFFA DI FISSAGGIO IN PLASTICA CON 6 VITI

837

| SIZE (mm) | CODE | TECH. CODE |
|-----------|-----------|--------------|
| 153/76 mm | 87.49.601 | MU0837STAF31 |

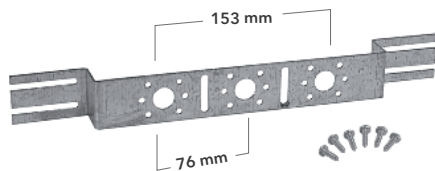
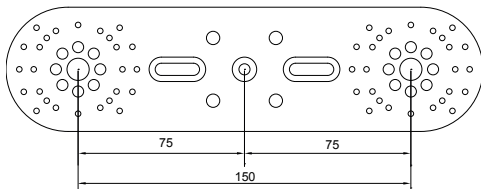

BUILT IN MOUNTING PLATE WITH 6 SCREWS

STAFFA DI FISSAGGIO AD INCASSO CON 6 VITI

837

| SIZE (mm) | CODE | TECH. CODE |
|-----------|-----------|--------------|
| 153/76 mm | 87.49.610 | MU0837STAF41 |

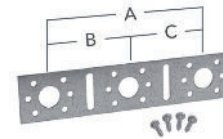

MOUNTING PLATE WITH 4 SCREWS

/ STAFFA DI FISSAGGIO CON 4 VITI

837

| SIZE (mm) | CODE | TECH. CODE |
|----------------------------------|-----------|--------------|
| A (153mm) - B/C (76mm) | 87.49.600 | MU0837STAF11 |
| A (200mm) - B (80mm) - C (120mm) | 87.49.605 | MU0837STAF21 |

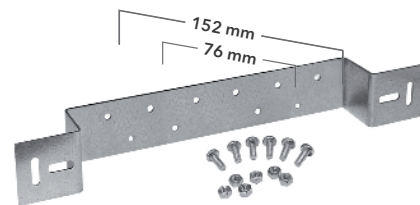
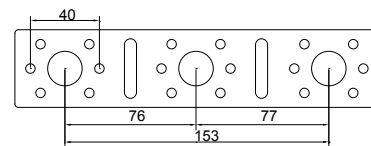

MOUNTING PLATE WITH 6 SCREWS AND NUTS

/ STAFFA DI FISSAGGIO CON 6 DADI E VITI

837

| SIZE (mm) | CODE | TECH. CODE |
|-----------|-----------|--------------|
| 76/152 mm | 87.54.075 | MU0837STAF01 |

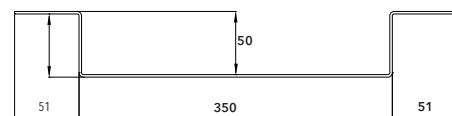
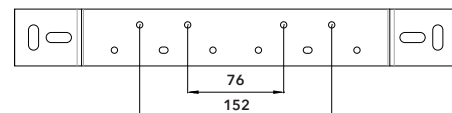



**PRESS FITTINGS FOR MULTILAYER PIPE
/ RACCORDI A PRESSARE PER TUBO MULTISTRATO**



**PRESS FITTINGS FOR MULTILAYER PIPE
/ RACCORDI A PRESSARE PER TUBO MULTISTRATO**

COMISA



WWW.COMISA.IT

Comisa S.p.A. reserves the right to make improvements and changes to products and related technical data at any time and without notice.
Comisa S.p.A. si riserva il diritto di apportare miglioramenti e modifiche a prodotti e relativi dati tecnici in qualsiasi momento e senza preavviso.