

# 3.63 PVC/PE Overgangskoppeling

## Productinformatie

### Materiaal

- PVC-U (Polyvinylchloride zonder weekmaker) en PE100

### Afdichting

- EPDM

### Vervaardiging

- Spuitgiet

## Onderdelen

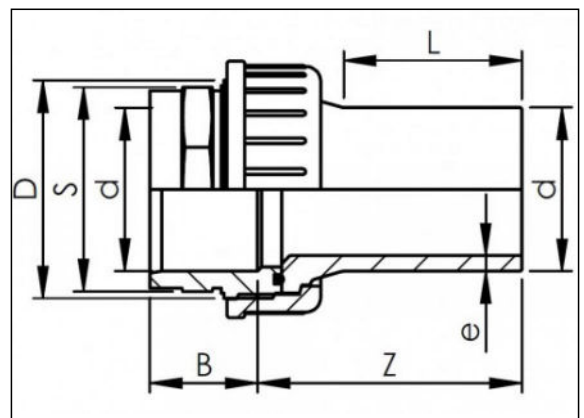

## Beschikbare artikelen

ART.CODE	d	D	B	Z	S	L	e	SDR	P (Bar)	Verp
3.63.050	50	2 1/4"	31	105	64	57	4.6	11	12.5	10
3.63.063	63	2 3/4"	38	116	80	70	5.8	11	12.5	3
3.63.064	63	2 3/4"	38	116	80	70	3.8	17	7.5	3
3.63.075	75	ZGTD	44	140	94	81	6.8	11	7.5	3
3.63.076	75	ZGTD	44	140	94	81	4.5	17	7.5	10
3.63.090	90	ZGTD	51	159	114	90	8.2	11	7.5	2
3.63.091	90	ZGTD	51	159	114	90	5.4	17	7.5	6

### Van de Lande BV

Lissenveld 1 \ 4941 VK Raamsdonksveer \ The Netherlands \ t +31 (0)162 51 60 00 \ f +31 (0)162 52 14 17 \ sales@vandelande.com  
 Traderegister Tilburg: 18070844 \ IBAN: NL13 RABO 0143 0035 26 \ BIC: RABONL2U \ VAT: NL 8123.91.755.B01

ART.CODE	d	D	B	Z	S	L	e	SDR	P (Bar)	Verp
3.63.110	110	ZGTD	62	189	138	120	10	11	7.5	3
3.63.111	110	ZGTD	62	189	138	120	6.6	17	7.5	1

**Van de Lande BV**

Lissenveld 1 \ 4941 VK Raamsdonksveer \ The Netherlands \ t +31 (0)162 51 60 00 \ f +31 (0)162 52 14 17 \ sales@vandelande.com  
Traderegister Tilburg: 18070844 \ IBAN: NL13 RABO 0143 0035 26 \ BIC: RABONL2U \ VAT: NL 8123.91.755.B01

All our transactions are subject to the Van de Lande General Terms of Sale. A copy of these can be provided immediately upon your request.